

# Park 26

3,000 SF Available



## 1320 26th St NW, Bay 10 Auburn, WA 98001

3,000 SF available including 500 SF of office

---

Grade-level loading; 18' CH

---

Drive-thru; 12' x 12' door and 12' x 14' door

---

\$0.85 SF/month, NNN

*The information contained herein has been obtained from reliable sources, but is not guaranteed. A prospective buyer/tenant should verify each item relating to this property and all information contained herein.*

*Last Updated: June 2021*

## Contact

**SHANE MAHVI**  
(206) 336-5338  
[smahvi@andoverco.com](mailto:smahvi@andoverco.com)

**DAVE DUNN, CCIM**  
(206) 336-5326  
[ddunn@andoverco.com](mailto:ddunn@andoverco.com)

 **THE ANDOVER  
COMPANY, INC.**  
CORPORATE REAL ESTATE

# Bay 10

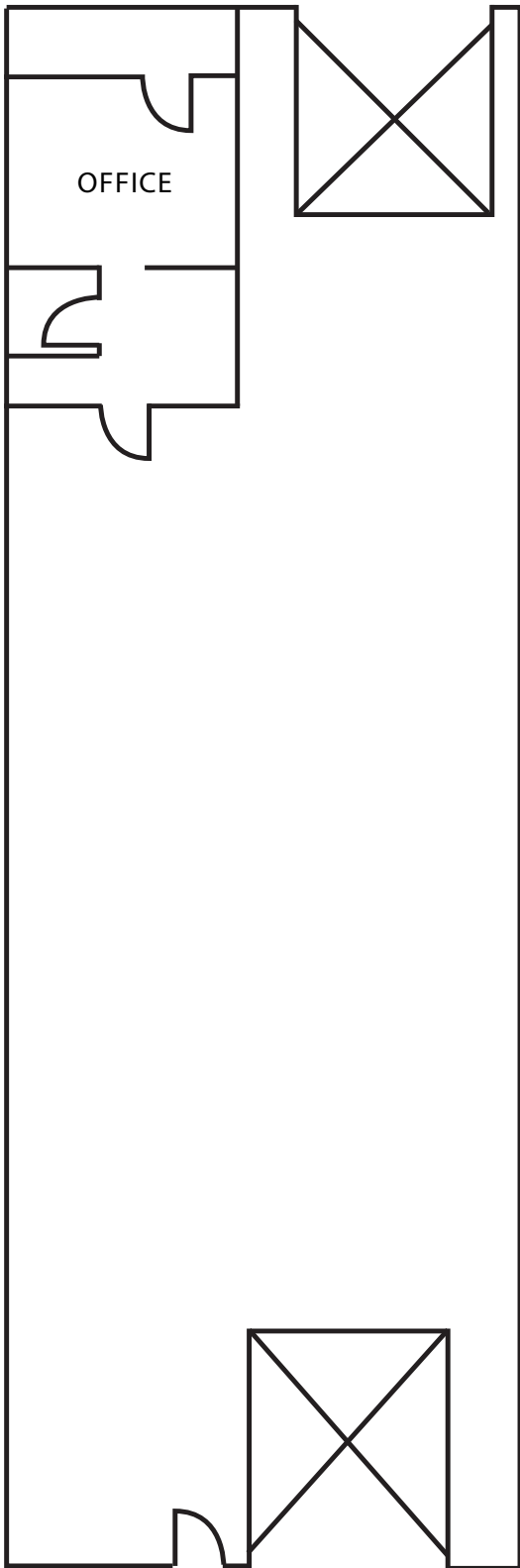

Bay: 10  
1320 26<sup>TH</sup> ST NW  
AUBURN, WA 98001

Total SF: 3,000 SF  
Rate: \$0.85 SF/MONTH, NNN

## Contact

SHANE MAHVI  
(206) 336-5338  
[smahvi@andoverco.com](mailto:smahvi@andoverco.com)

DAVE DUNN, CCIM  
(206) 336-5326  
[ddunn@andoverco.com](mailto:ddunn@andoverco.com)

*The information contained herein has been obtained from reliable sources, but is not guaranteed. A prospective buyer/tenant should verify each item relating to this property and all information contained herein.*

*Last Updated: June 2021*

