

# 7,200 SF

## Industrial Space For Lease



## Prologis Park Renton - Renton 6

820 Thomas Ave SW  
Renton, WA 98057

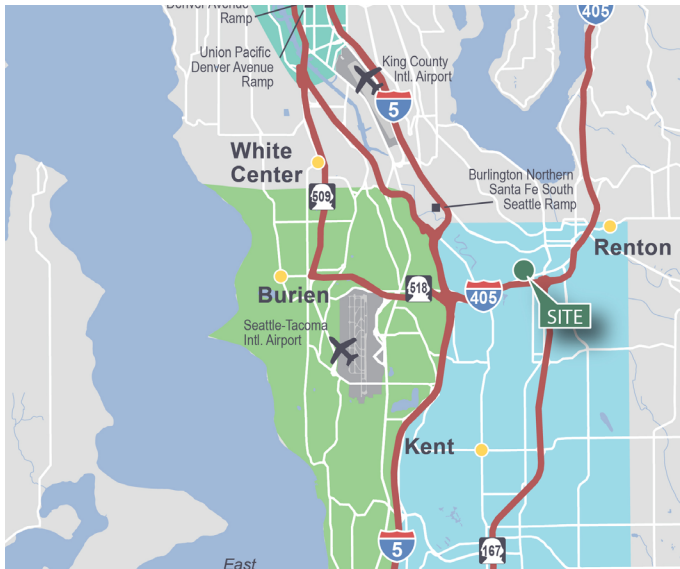

### LOCATION

- North of I-405. Great freeway access via West Valley Highway, Rainier Avenue South.

### FACILITY

- Property Type: Industrial
- Year Built: 1969
- Land: 5.67 AC
- Parking: 0.91/1,000 SF
- Total SF: 7,200 SF
- Office SF: 751 SF
- Clear Height: 22'
- Loading Doors: 1 Dock Door, 1 Drive-In Door, and 1 Rail Door
- Rate: Call broker, Brian Bruininks, CCIM for rates
- Available: December 1st, 2021, please call broker to arrange access/ tour

### ADVANTAGES AND AMENITIES

- High-efficiency fluorescent lighting, no city of Seattle B&O tax.

# 7,200 SF

## Industrial Space For Lease

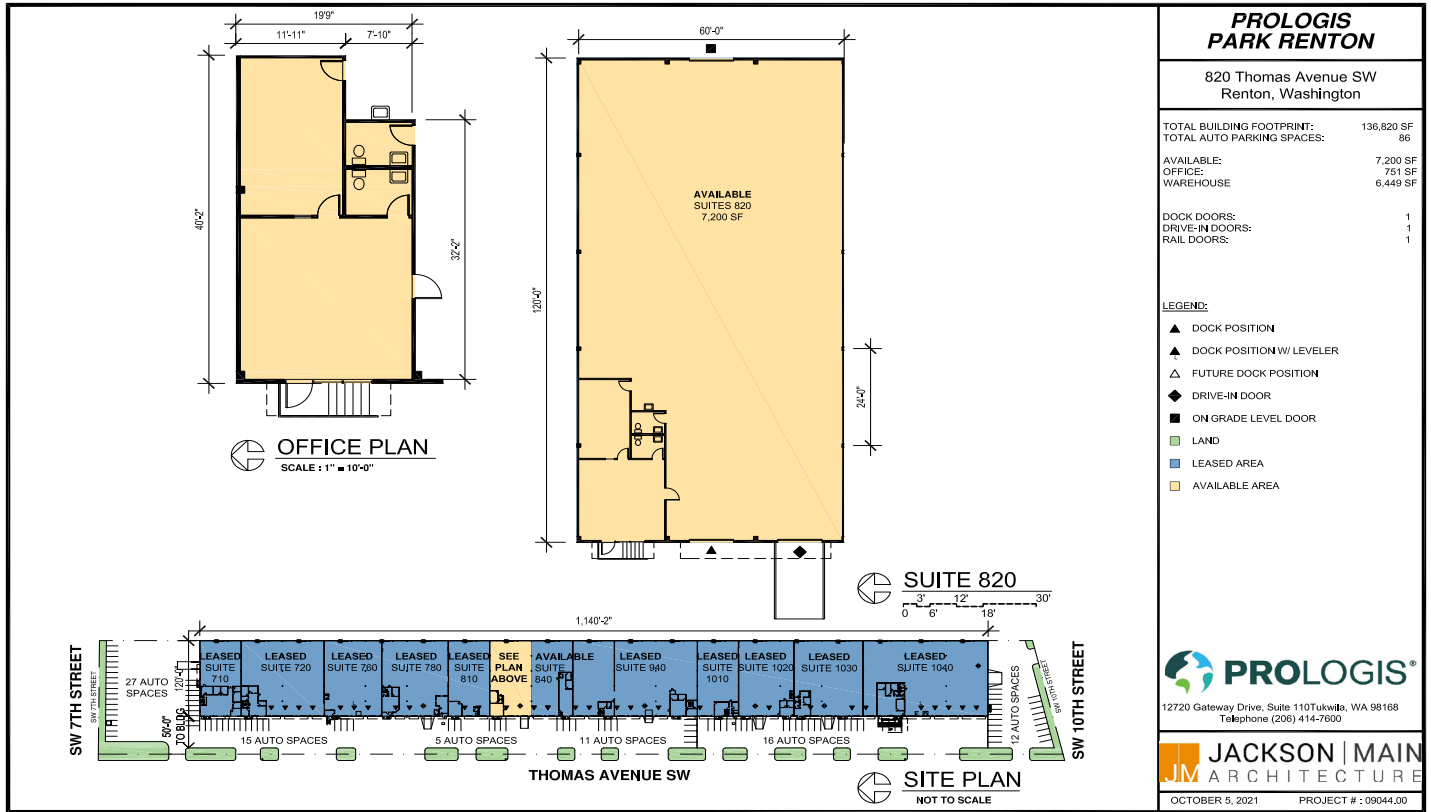

**The Andover Company, Inc.**  
**Brian Bruininks, CCIM**  
 bbruininks@andoverco.com  
 ph +1 206 336 5324  
 cell +1 206 856 6249  
 900 SW 16th St  
 Ste 100  
 Renton, WA 98057 USA

**Prologis**  
**Kimberley Nemethy**  
 knemethy@prologis.com  
 ph +1 206 414 7616  
 cell +1 253 508 1737  
 33930 Weyerhaeuser Way S  
 Ste 100  
 Federal Way, WA 98001 USA