

FOR LEASE
B106: 13,506 SF

WEST PARK CORPORATE CAMPUS
3500 W VALLEY HWY N | AUBURN, WA



FEATURES

- 13,506 SF total
- Includes 2,770 SF of office space
- 3 dock high doors, 1 oversized grade level door
- 2,770 SF bonus storage mezzanine
- 200 Amps at 480 Volts, 3-phase power
- 30' Clear Height
- Sprinklered
- Class A image
- Excellent Highway 167 frontage
- Excellent access and proximity to I-5, SR-18 and Hwy-167
- Built in 2000
- Available April 1, 2022
- **Call broker for rates**

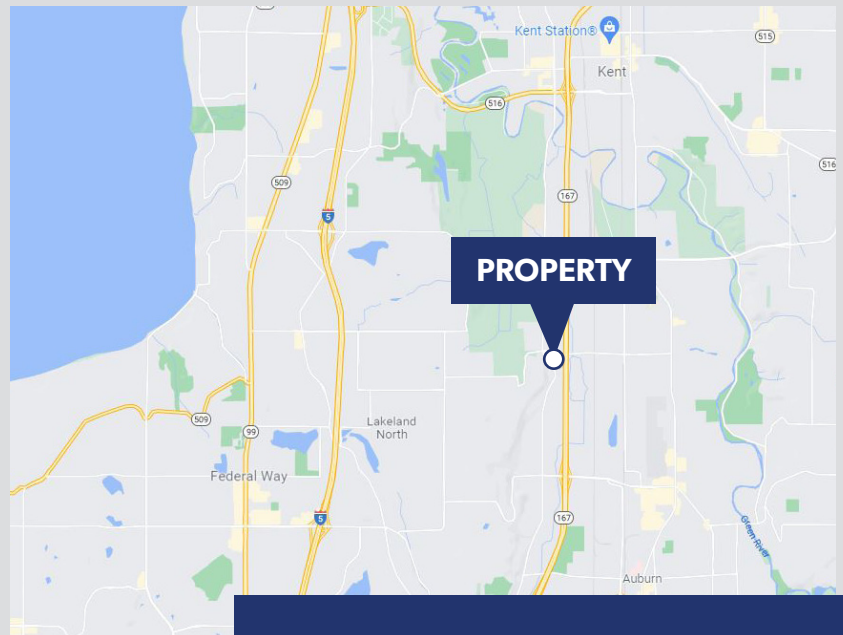

EXCLUSIVELY OFFERED BY:

Arne Svendsen
(206) 947-2885
asvendsen@andoverco.com

Brian Bruininks, CCIM
(206) 336-5324
bbuininks@andoverco.com

West Park Corporate Campus is owned and operated by:



FOR LEASE
B106: 13,506 SF

WEST PARK CORPORATE CAMPUS

3500 W VALLEY HWY N | AUBURN, WA



ADDRESSES

- Building A: 1220 37th St NW
- Building B: 3500 W Valley Hwy N
- Building C: 3402 W Valley Hwy N
- Building D: 3320 W Valley Hwy N

EXCLUSIVELY OFFERED BY:

Arne Svendsen
(206) 947-2885
asvendsen@andoverco.com

Brian Bruininks, CCIM
(206) 336-5324
bbruininks@andoverco.com



THE ANDOVER COMPANY, INC./CORFAC INTERNATIONAL
900 SW 16th St, Ste 100 | Renton, WA 98057 | (206) 244-0770 | www.andoverco.com

West Park Corporate Campus is owned and operated by:



The information contained herein has been obtained from reliable sources, but is not guaranteed. A prospective buyer/tenant should verify each item relating to this property and all information contained herein.

FOR LEASE
B106: 13,506 SF

WEST PARK CORPORATE CAMPUS
3500 W VALLEY HWY N | AUBURN, WA

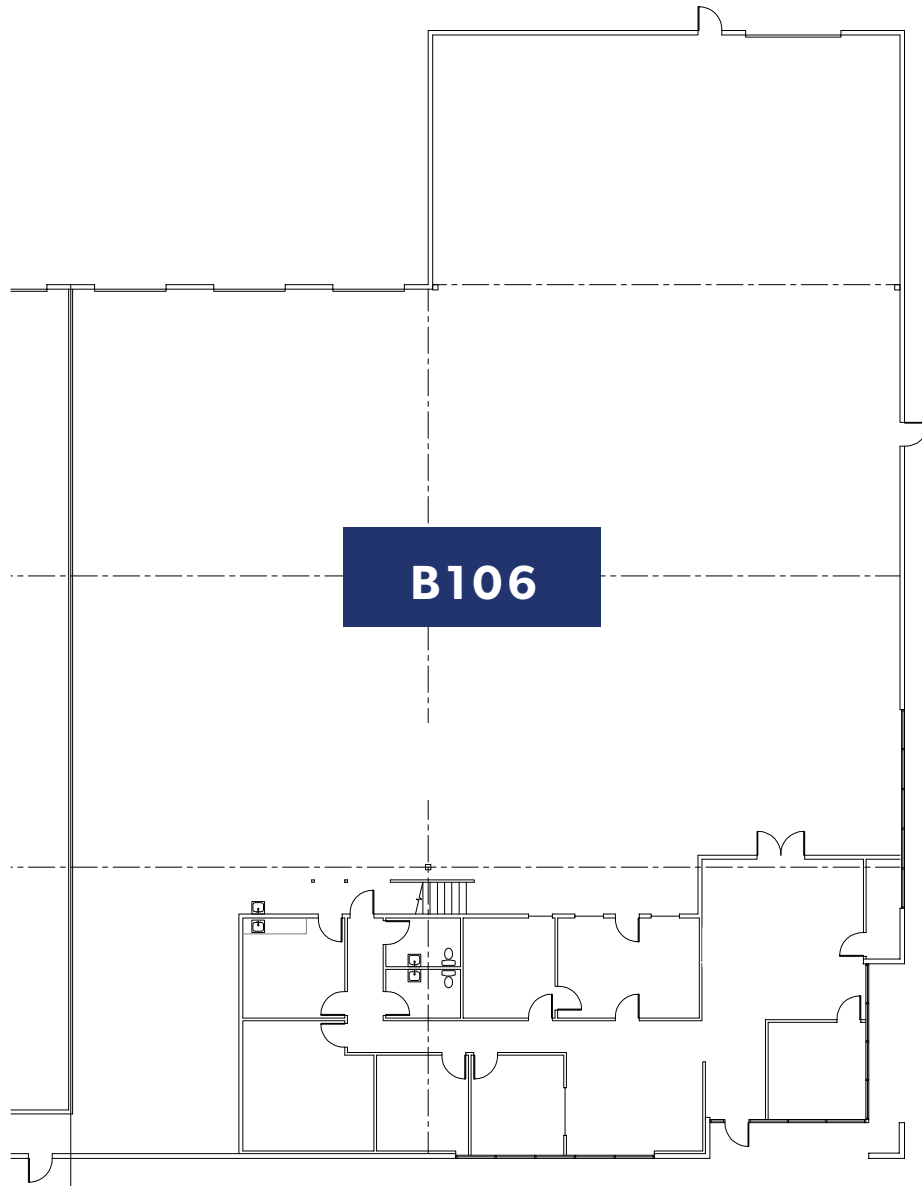

EXCLUSIVELY OFFERED BY:

Arne Svendsen
(206) 947-2885
asvendsen@andoverco.com

Brian Bruininks, CCIM
(206) 336-5324
bbuininks@andoverco.com

West Park Corporate Campus is owned and operated by:

