

PACIFIC INDUSTRIAL PARK
15000 40th Ave NE | Marysville, WA

10,800 SF
FOR SUBLEASE



Property Highlights

- Office: 1,785 SF
- Three (3) oversized 14' x 16' GL doors
- 24' clear height
- Located in a burgeoning industrial development area (Amazon Fulfillment Center just opening)
- Excellent parking ratio
- Insulated
- **Contact broker for rates**
- **Available now, lease term through 3/31/28**

BRUCE CLARKSON

(206) 336-5332

bclarkson@andoverco.com



The information contained herein has been obtained from reliable sources, but is not guaranteed. A prospective buyer/tenant should verify each item relating to this property and all information contained herein.

PACIFIC INDUSTRIAL PARK
15000 40th Ave NE | Marysville, WA

10,800 SF
FOR SUBLEASE

SUITE 101
10,800 SF

▲ GL Door

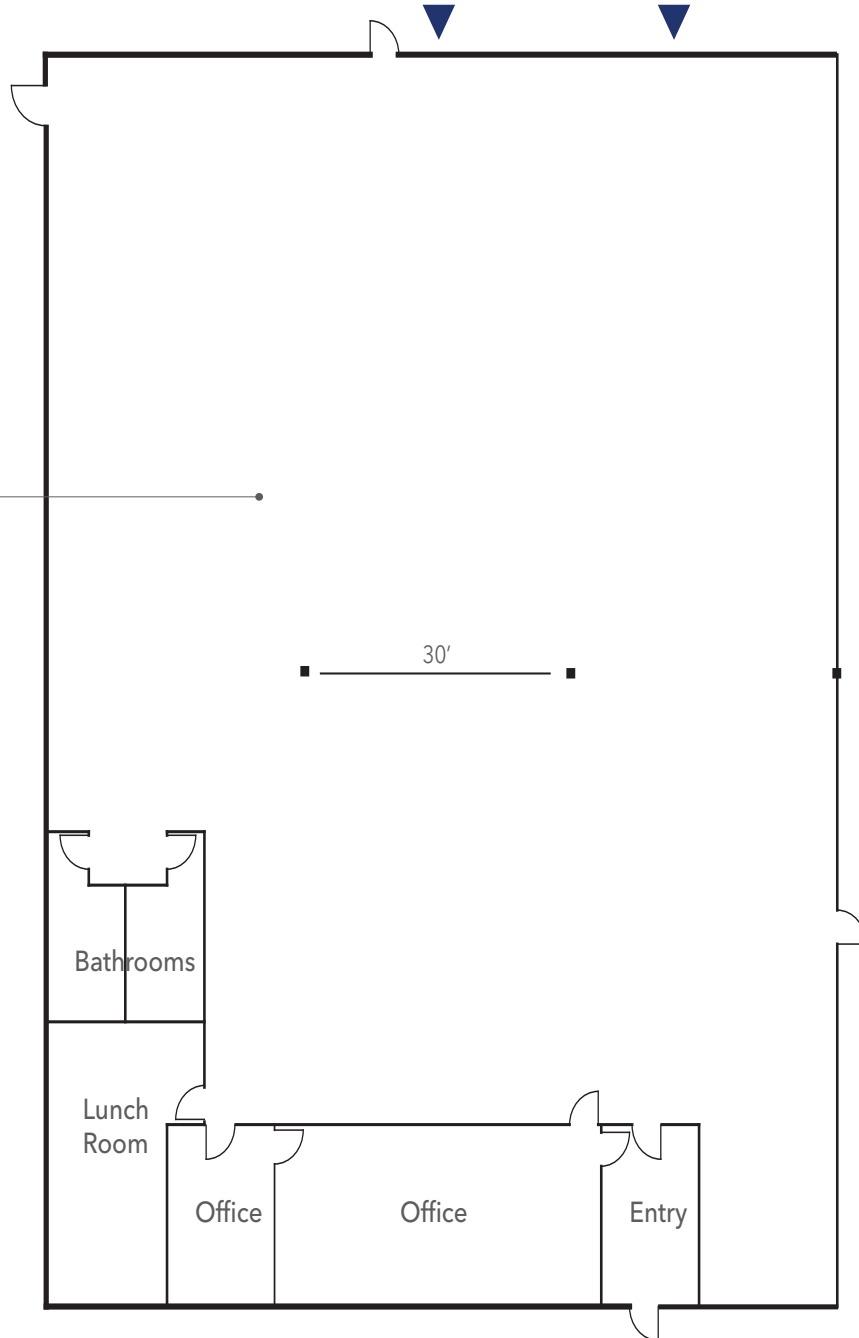

BRUCE CLARKSON
(206) 336-5332
bclarkson@andoverco.com

The information contained herein has been obtained from reliable sources, but is not guaranteed. A prospective buyer/tenant should verify each item relating to this property and all information contained herein.