

FOR SUBLEASE

C100: 15,559 SF

WEST PARK CORPORATE CAMPUS

3402 W VALLEY HWY N | AUBURN, WA



## DOCK HIGH WAREHOUSE/OFFICE SPACE

### HIGHLIGHTS

- 15,559 SF Total
- 1,177 SF of office
- 2 Dock high doors (1 pit-leveler)
- 1 Grade level (oversized)
- 3-phase power
- 30' clear height
- Excellent office layout
- Sprinklered
- Excellent highway 167 frontage
- Class A image
- Excellent access and proximity to I-5, SR-18 and Hwy-167
- Built in 2000
- Sublease term through 7/31/28
- **Contact brokers for rates**

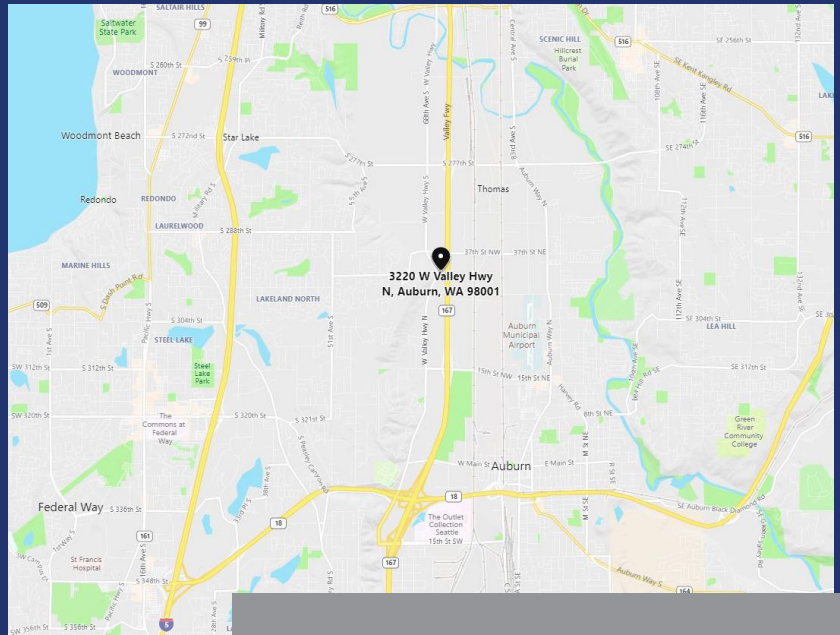

EXCLUSIVELY OFFERED BY:

**Arne Svendsen**  
(206) 947-2885  
asvendsen@andoverco.com



THE ANDOVER COMPANY, INC./CORFAC INTERNATIONAL  
900 SW 16th St, Ste 100 | Renton, WA 98057 | (206) 244-0770 | [www.andoverco.com](http://www.andoverco.com)

West Park Corporate Campus is owned and operated by:



The information contained herein has been obtained from reliable sources, but is not guaranteed. A prospective buyer/tenant should verify each item relating to this property and all information contained herein.

FOR SUBLEASE

C100: 15,559 SF

WEST PARK CORPORATE CAMPUS

3402 W VALLEY HWY N | AUBURN, WA



## ADDRESSES

- Building **A**: 1220 37th St NW
- Building **B**: 3500 W Valley Hwy N
- Building **C**: 3402 W Valley Hwy N
- Building **D**: 3320 W Valley Hwy N

EXCLUSIVELY OFFERED BY:

**Arne Svendsen**  
(206) 947-2885  
asvendsen@andoverco.com

West Park Corporate Campus is owned and operated by:



THE ANDOVER COMPANY, INC./CORFAC INTERNATIONAL  
900 SW 16th St, Ste 100 | Renton, WA 98057 | (206) 244-0770 | [www.andoverco.com](http://www.andoverco.com)

*The information contained herein has been obtained from reliable sources, but is not guaranteed. A prospective buyer/tenant should verify each item relating to this property and all information contained herein.*

FOR SUBLEASE

C100: 15,559 SF

# WEST PARK CORPORATE CAMPUS

3402 W VALLEY HWY N | AUBURN, WA

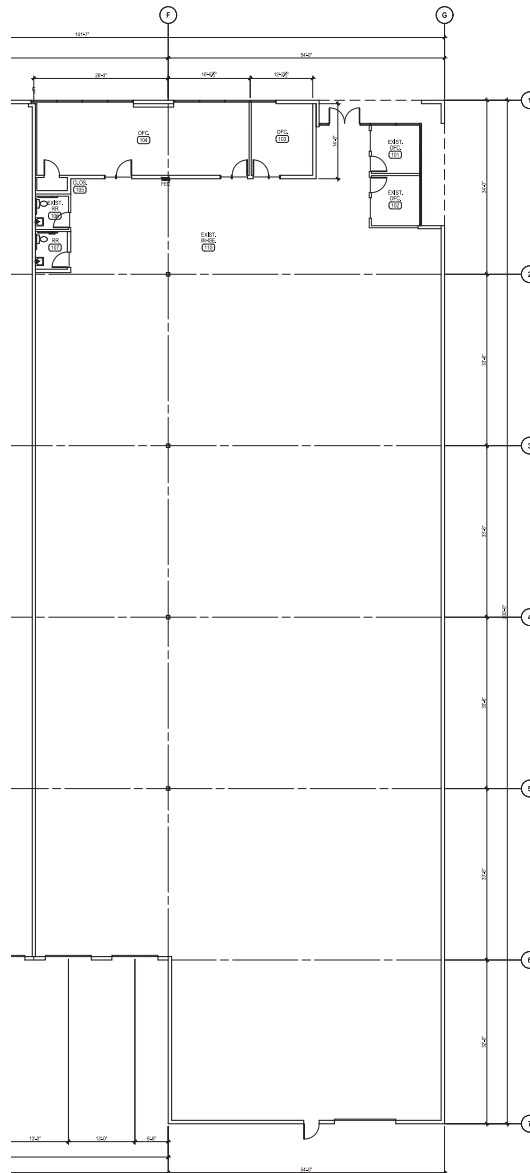

EXCLUSIVELY OFFERED BY:

**Arne Svendsen**  
(206) 947-2885  
asvendsen@andoverco.com

West Park Corporate Campus is owned and operated by:

