

# KENT WEST

CORPORATE PARK

FOR LEASE  
47,821 SF

AVAILABLE 12/1/24  
OR SOONER



THE ANDOVER  
COMPANY, INC.

CORFAC INTERNATIONAL

**BRIAN BRUININKS, CCIM**  
(206) 336-5324  
bbruininks@andoverco.com

**SHANE MAHVI**  
(206) 336-5338  
smahvi@andoverco.com

# SITE PLAN

AVAILABLE:

47,821 SF - SUITE 21901

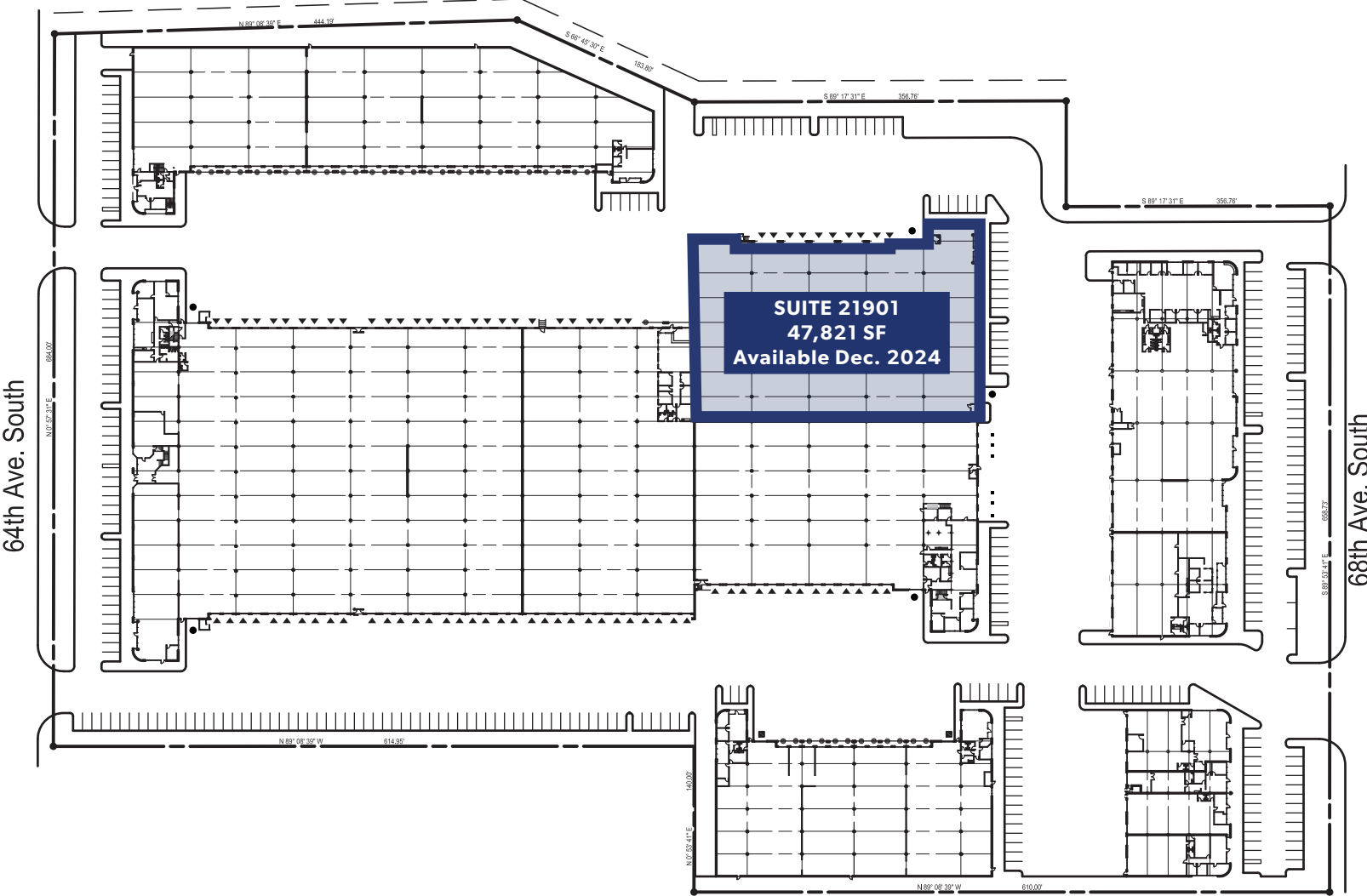

The information contained herein has been obtained from reliable sources, but is not guaranteed. A prospective buyer/tenant should verify each item relating to this property and all information contained herein.



# 47,821 SF TOTAL

Size: **47,821 SF TOTAL**

Office Space: **76 SF (RESTROOMS)**

Clear Height: **24'**

Docks: **10 (5 Pit Levelers, 1 Edge of Dock Levelers )**

Grade Level: **2 ( 1 oversized 12' x 14')**

Available: **12/01/24 or sooner**

Notes: **End cap space with unopposed truck court.**  
**Please call Brian and Shane for rates, operating expenses and to arrange a site visit.**

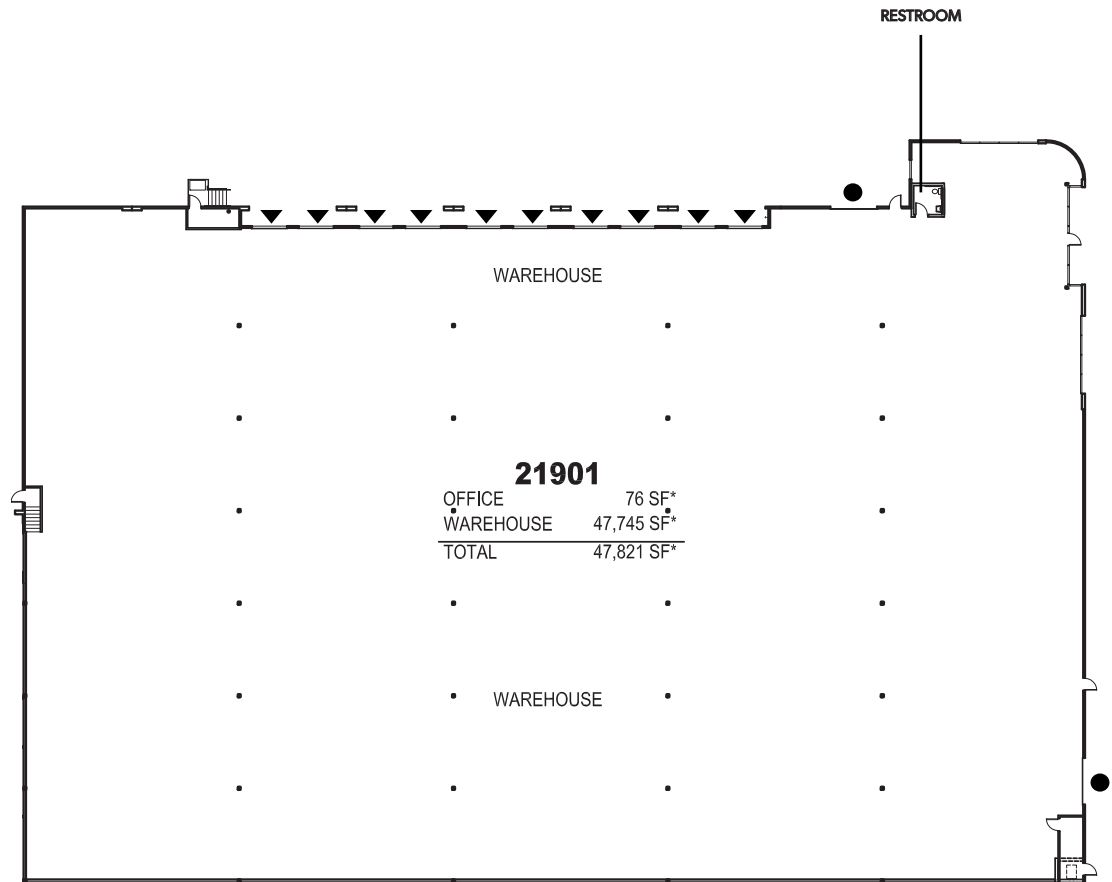
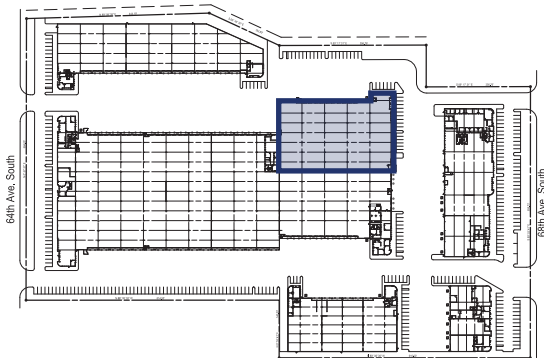

- ▲ Dock high door
- Drive-in door

**21901 67TH AVE S**  
**KENT, WA**

**BRIAN BRUININKS, CCIM**  
(206) 336-5324  
bbreininks@andoverco.com

**SHANE MAHVI**  
(206) 336-5338  
smahvi@andoverco.com

**THE ANDOVER**  
**COMPANY, INC.**  
CORFAC INTERNATIONAL



# CONVENIENT COMMUTE

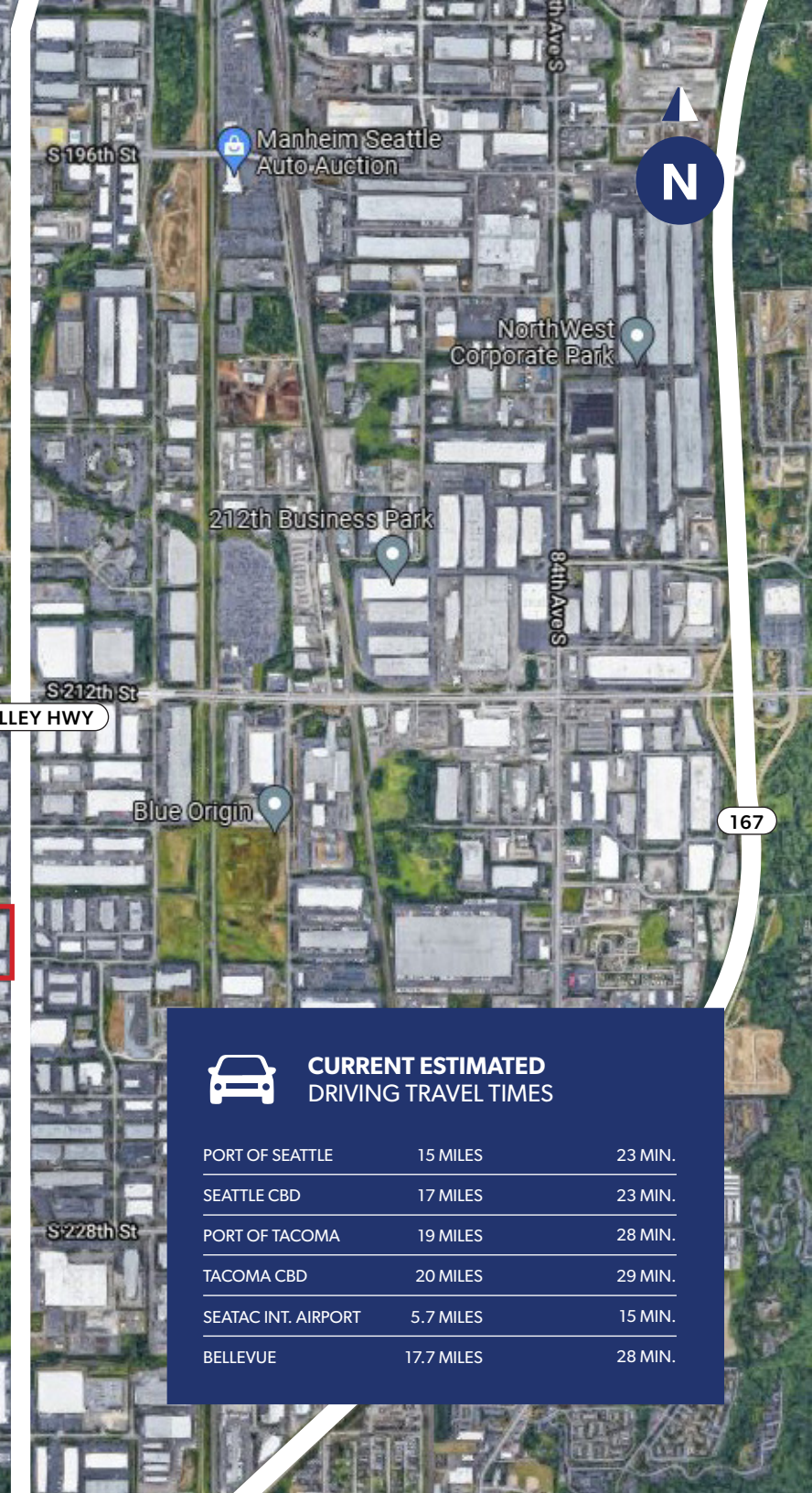

	CURRENT ESTIMATED DRIVING TRAVEL TIMES	
PORT OF SEATTLE	15 MILES	23 MIN.
SEATTLE CBD	17 MILES	23 MIN.
PORT OF TACOMA	19 MILES	28 MIN.
TACOMA CBD	20 MILES	29 MIN.
SEATAC INT. AIRPORT	5.7 MILES	15 MIN.
BELLEVUE	17.7 MILES	28 MIN.



# KENT WEST

## CORPORATE PARK



**BRIAN BRUININKS, CCIM**  
(206) 336-5324  
bbruininks@andoverco.com

**SHANE MAHVI**  
(206) 336-5338  
smahvi@andoverco.com