

Centerpointe Business Park

18000 | 72nd Avenue South
Kent, WA



3,954 SF, 8,756 SF & 12,710 SF

Flex/Industrial Spaces



THE ANDOVER
COMPANY, INC.

CORFAC INTERNATIONAL

BRIAN BRUININKS, CCIM
(206) 856-6249
bbruininks@andoverco.com

MIKE HEMPHILL
(206) 550-4176
mhemphill@andoverco.com

PROPERTY HIGHLIGHTS



MODERN
OFFICE SPACE



14' - 16'+
CLEAR HEIGHT



NUMEROUS
GRADE LEVEL
DOORS



SOME SUITES HAVE
ACCESS TO DOCK
HIGH LOADING DOORS



AVAILABILITIES
IN 2025



RATES:
PLEASE CALL LISTING
BROKERS

AVAILABLE SPACES

3,954 SF - 12,710 SF

SUITE	TOTAL SF	OFFICE SF	WAREHOUSE SF	LOADING	COMMENTS
18034	3,954 SF	2,274 SF	1,680 SF	<p>Loading area is designed to accommodate larger delivery trucks. 1 grade level door, 1 dock high door.</p>	<ul style="list-style-type: none"> • Great flex/industrial space at north end of Kent. • Office area has four private offices, conference room and open work area. • Warehouse has 14' clear height. • Available 10/01/2025
18064	8,756 SF	3,316 SF	5,440 SF	<p>Loading area is designed to accommodate larger delivery trucks. 1 grade level door, 1 dock high door.</p>	<ul style="list-style-type: none"> • Great flex industrial space at north end of Kent. • Office area has two private offices, conference room, and break room. • Warehouse has 16'9" clear height. • Available 10/01/2025
18034 & 18064	12,710 SF	5,590 SF	7,120 SF	<p>Loading area is designed to accommodate larger delivery trucks. 2 grade level doors, 2 dock high doors.</p>	<ul style="list-style-type: none"> • Great flex industrial space at north end of Kent. • Space has two office entries. • The office area is a mix of private offices, open space, conference room and break room. • Warehouse has 16'9" and 14' clear heights. • Available 10/01/2025

PROPERTY PHOTOS



18034/18064 | 72nd Avenue South Kent, WA

SUITE 18034 + 18064

Total SF: **12,710 SF**

Office SF: **5,590 SF**

Warehouse SF: **7,120 SF**

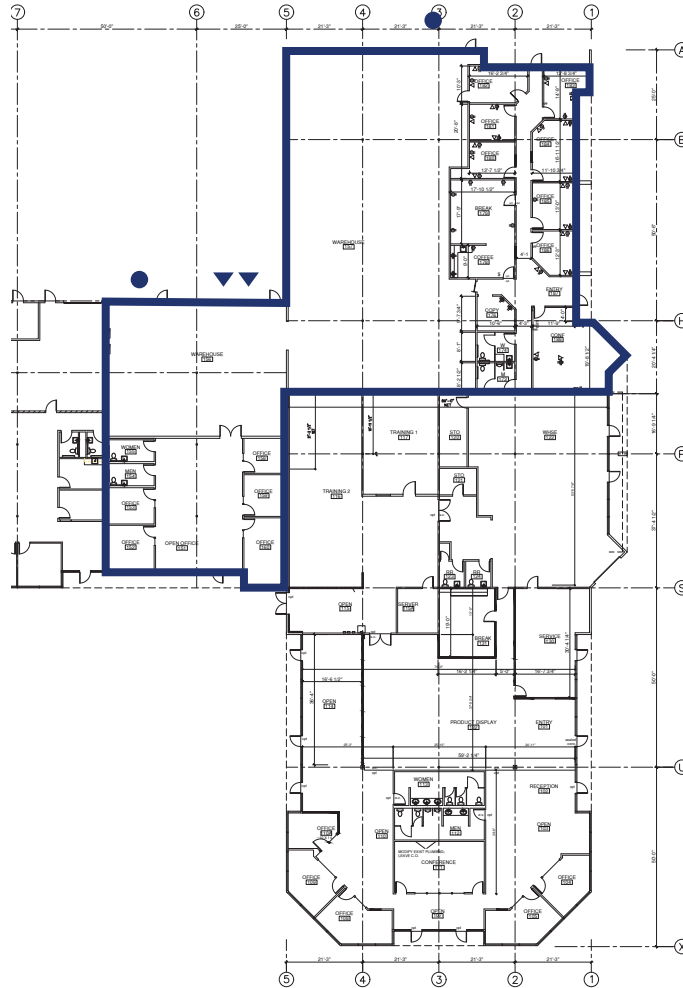

- ▲ Dock high door
- Grade level door

BRIAN BRUININKS, CCIM
(206) 856-6249
bbruininks@andoverco.com

MIKE HEMPHILL
(206) 550-4176
mhemphill@andoverco.com



18034/18064 | 72nd Avenue South Kent, WA

SUITE 18064

Total SF: **8,756 SF**
Office SF: **3,316 SF**
Warehouse SF: **5,440 SF**

SUITE 18034

Total SF: **3,954 SF**
Office SF: **2,274 SF**
Warehouse SF: **1,680 SF**

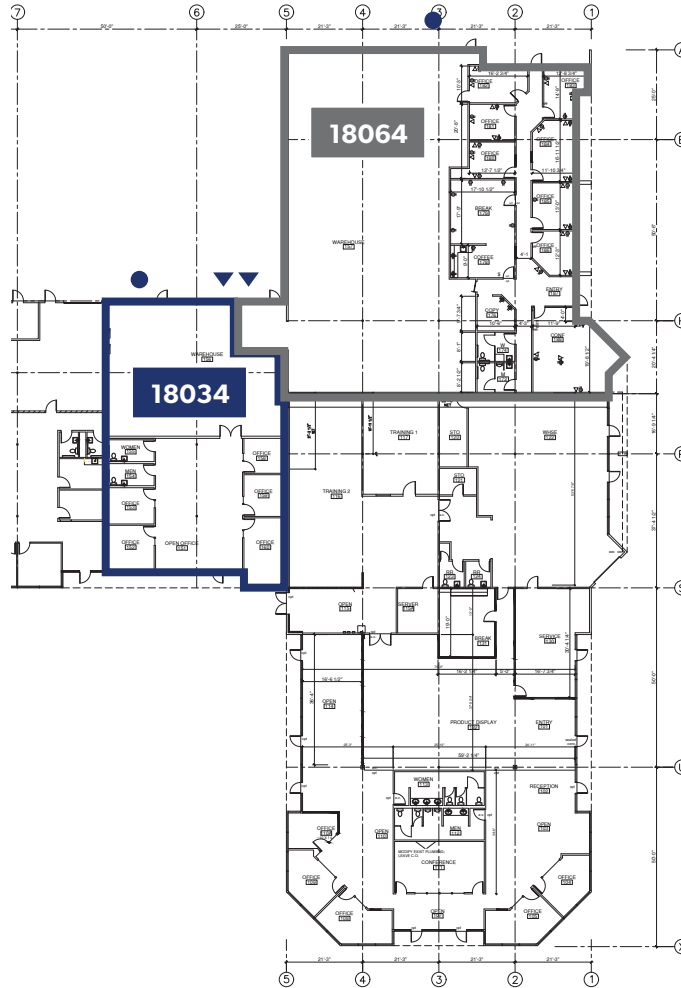

- ▲ Dock high door
- Grade level door

BRIAN BRUININKS, CCIM
(206) 856-6249
bbruininks@andoverco.com

MIKE HEMPHILL
(206) 550-4176
mhemphill@andoverco.com

