

CENTRAL COMMERCE CENTER

8326-8330 S 259th St, Kent, WA

Available 4/1/2025

Warehouse/Flex Space



Property Specifications

- 8,985 SF Shell (divisible to 3,598 SF & 5,314 SF)
- 4,426 SF Office
- 13' Clear Height
- 2 Grade Level Doors (1 oversized 12' x 12')
- 250 amps, 277/480v, 3-phase power
- 100 amps, 120/208v, 3-phase power
- To be improved with: New LED lighting, carpet tiles and paint

Property Features

- End Cap Space
- Ample Parking
- Excellent access to Hwy-167 and Downtown Kent
- Professional image business park
- Responsive Local Ownership



CENTRAL COMMERCE CENTER

8326-8330 S 259th St, Kent, WA

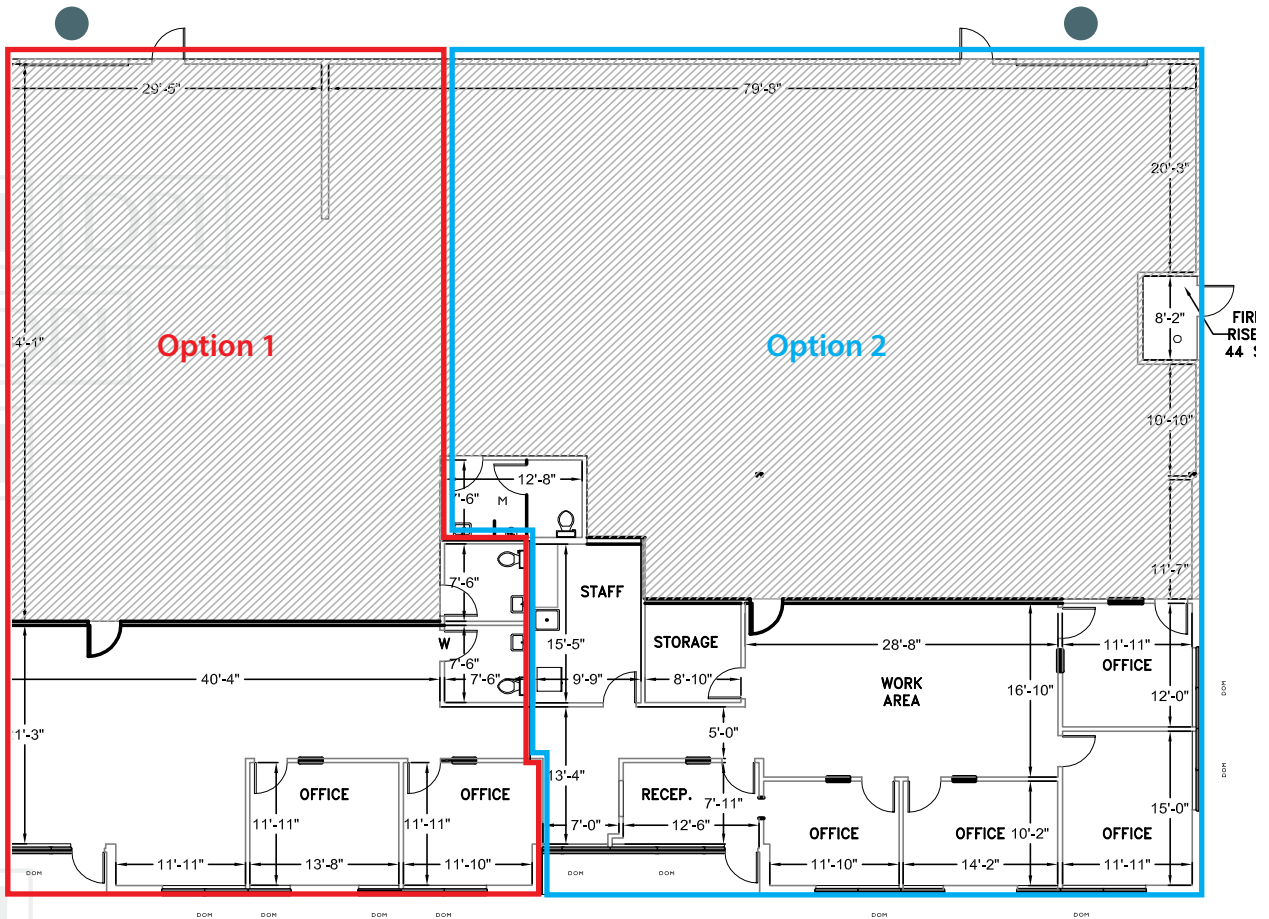

Divisible Option 1: Suite 8326
 3,598 SF Total
 1,374 SF Office
 13' Clear Height
 1 Grade Level Door

Divisible Option 2: Suite 8330
 5,314 SF Total
 1,922 SF Office
 13' Clear Height
 1 Grade Level Door (Oversized 12'x12')
 End Cap Space

Contact Andover for more info:

Brian Bruininks, CCIM
 206-856-6249
 bbruininks@andoverco.com

Shane Mahvi, SIOR
 858-442-0441
 smahvi@andoverco.com

Lisa Rowe
 206-777-5122
 lisar@dpillc.com

The information provided in this document should be independently verified on any material matter represented herein.

Owned & Operated by:



dpillc.com