

# Centerpointe Business Park

18000 | 72<sup>nd</sup> Avenue South  
Kent, WA



3,954 SF, 8,756 SF & 12,710 SF

## Flex/Industrial Spaces

 THE ANDOVER  
COMPANY, INC.  
CORFAC INTERNATIONAL

**BRIAN BRUININKS, CCIM**  
(206) 856-6249  
bbruininks@andoverco.com

**MIKE HEMPHILL**  
(206) 550-4176  
mhemphill@andoverco.com

# PROPERTY HIGHLIGHTS



MODERN  
OFFICE SPACE



14' - 16'+  
CLEAR HEIGHT



NUMEROUS  
GRADE LEVEL  
DOORS



SOME SUITES HAVE  
ACCESS TO DOCK  
HIGH LOADING DOORS



AVAILABILITIES  
IN 2025



RATES:  
PLEASE CALL LISTING  
BROKERS

# AVAILABLE SPACES

## 3,954 SF - 12,710 SF

SUITE	TOTAL SF	OFFICE SF	WAREHOUSE SF	LOADING	COMMENTS
18034	3,954 SF	2,274 SF	1,680 SF	<p>Loading area is designed to accommodate larger delivery trucks. 1 grade level door, 1 dock high door.</p>	<ul style="list-style-type: none"> <li>• Great flex/industrial space at north end of Kent.</li> <li>• Office area has four private offices, conference room and open work area.</li> <li>• Warehouse has 14' clear height.</li> <li>• Available 10/01/2025</li> </ul>
18064	8,756 SF	3,316 SF	5,440 SF	<p>Loading area is designed to accommodate larger delivery trucks. 1 grade level door, 1 dock high door.</p>	<ul style="list-style-type: none"> <li>• Great flex industrial space at north end of Kent.</li> <li>• Office area has two private offices, conference room, and break room.</li> <li>• Warehouse has 16'9" clear height.</li> <li>• Available 10/01/2025</li> </ul>
18034 & 18064	12,710 SF	5,590 SF	7,120 SF	<p>Loading area is designed to accommodate larger delivery trucks. 2 grade level doors, 2 dock high doors.</p>	<ul style="list-style-type: none"> <li>• Great flex industrial space at north end of Kent.</li> <li>• Space has two office entries.</li> <li>• The office area is a mix of private offices, open space, conference room and break room.</li> <li>• Warehouse has 16'9" and 14' clear heights.</li> <li>• Available 10/01/2025</li> </ul>

# PROPERTY PHOTOS



# 18034/18064 | 72<sup>nd</sup> Avenue South Kent, WA

## SUITE 18034 + 18064

Total SF: **12,710 SF**

Office SF: **5,590 SF**

Warehouse SF: **7,120 SF**

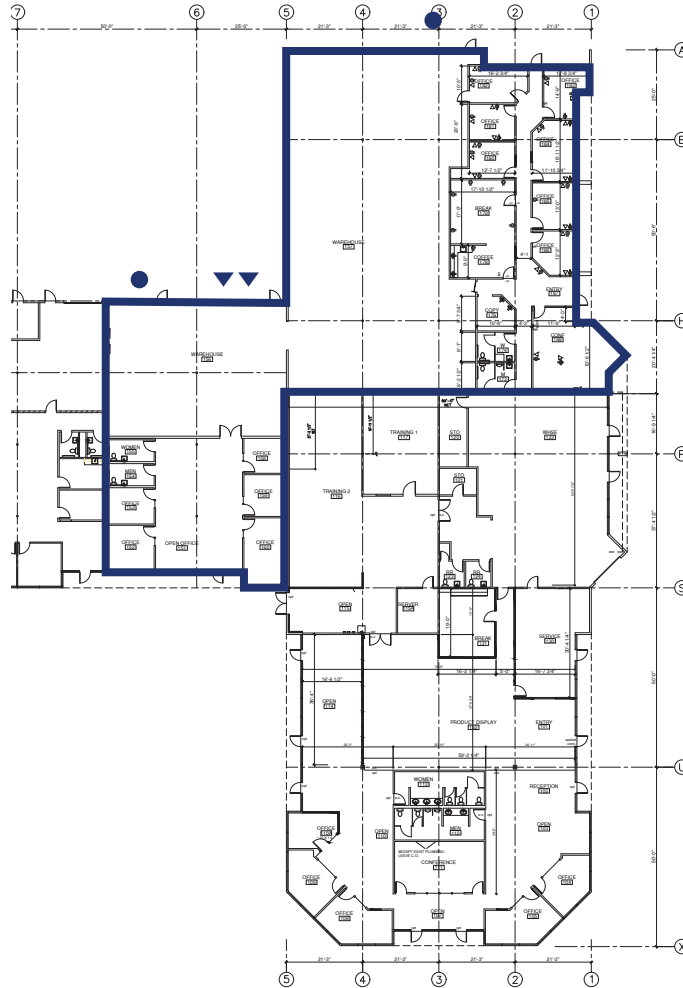

▲ Dock high door

● Grade level door

**BRIAN BRUININKS, CCIM**  
(206) 856-6249  
bbruininks@andoverco.com

**MIKE HEMPHILL**  
(206) 550-4176  
mhemphill@andoverco.com



# 18034/18064 | 72<sup>nd</sup> Avenue South Kent, WA

## SUITE 18064

Total SF: **8,756 SF**  
Office SF: **3,316 SF**  
Warehouse SF: **5,440 SF**

## SUITE 18034

Total SF: **3,954 SF**  
Office SF: **2,274 SF**  
Warehouse SF: **1,680 SF**

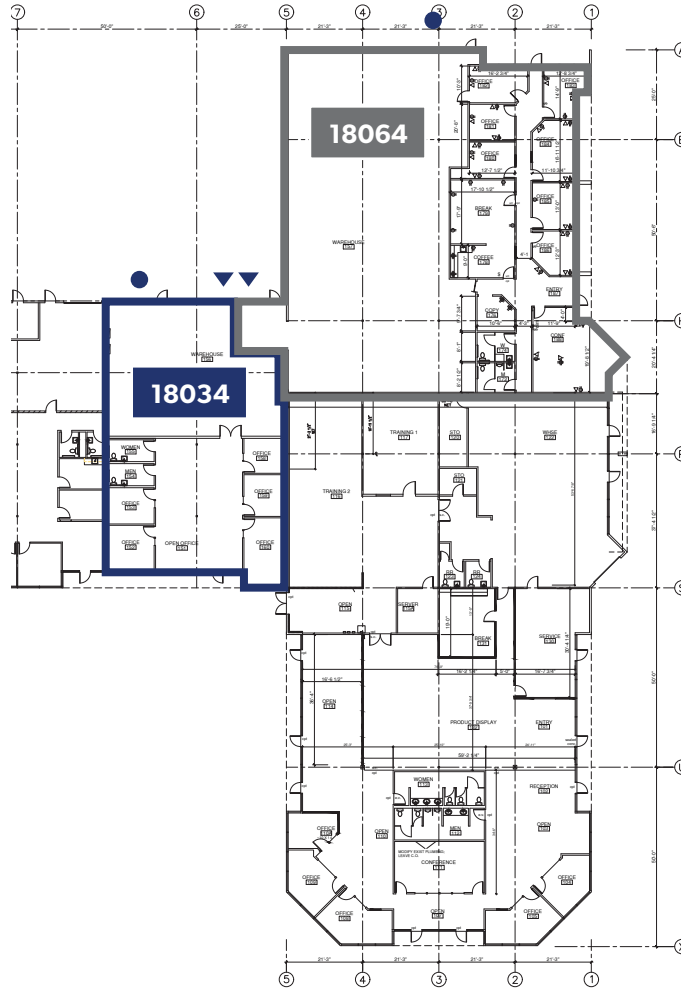

- ▲ Dock high door
- Grade level door

**BRIAN BRUININKS, CCIM**  
(206) 856-6249  
bbruininks@andoverco.com

**MIKE HEMPHILL**  
(206) 550-4176  
mhemphill@andoverco.com

