

# Occidental BUSINESS PARK

2454 Occidental Ave S Seattle, WA

## FOR LEASE

### 18,860 SF

INSULATED & CLIMATE CONTROLLED  
FULLY FENCED & SECURED



THE ANDOVER  
COMPANY, INC.

CORFAC INTERNATIONAL



**GEORGE ROCKWELL, SIOR**  
(206) 336-5328  
[grockwell@andoverco.com](mailto:grockwell@andoverco.com)

**SHANE MAHVI, SIOR**  
(206) 336-5338  
[smahvi@andoverco.com](mailto:smahvi@andoverco.com)

# Occidental BUSINESS PARK

2454 Occidental Ave S Seattle, WA

- 18,860 SF TOTAL  
(DIVISIBLE TO APPROX. 9,430 SF)
- 4,799 SF OFFICE
- 4 DOCK DOORS, WITH ABILITY TO ADD  
4 ADDITIONAL DOCK HIGH DOORS
- 1 OVERSIZED GRADE LEVEL DOOR
- 16' CLEAR HEIGHT
- INSULATED WAREHOUSE
- GREAT FOR CLIMATE CONTROLLED, FLEX  
AND R&D USES
- FENCED/GATED SITE WITH WROUGHT  
IRON
- +/- 600 AMPS, 480/277V, 3-PHASE  
POWER
- DEMISING WALL CAN BE DEMOED

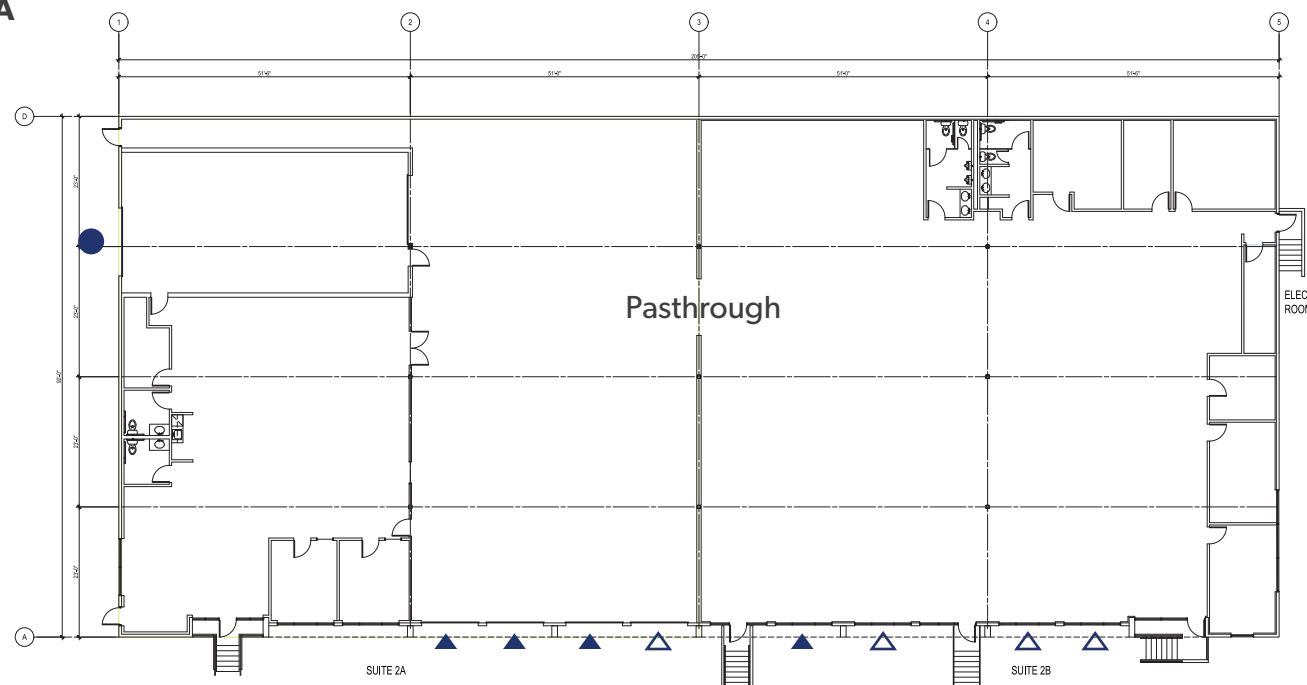

## KEY:

- ▲ Dock High Door
- △ Currently filled in with glass, LL has ability to convert into dock high as needed
- Grade Level Door



*The information contained herein has been obtained from reliable sources, but is not guaranteed. A prospective buyer/tenant should verify each item relating to this property and all information contained herein.*

**George Rockwell, SIOR**  
(206) 336-5328  
grockwell@andoverco.com

**Shane Mahvi, SIOR**  
(206) 336-5338  
smahvi@andoverco.com

**THE ANDOVER  
COMPANY, INC.**  
CORFAC INTERNATIONAL





# Occidental BUSINESS PARK

2454 Occidental Ave S Seattle, WA



*The information contained herein has been obtained from reliable sources, but is not guaranteed. A prospective buyer/tenant should verify each item relating to this property and all information contained herein.*

**George Rockwell, SIOR**  
(206) 336-5328  
grockwell@andoverco.com

**Shane Mahvi, SIOR**  
(206) 336-5338  
smahvi@andoverco.com

 **THE ANDOVER  
COMPANY, INC.**  
CORFAC INTERNATIONAL







LUMEN FIELD



T-MOBILE PARK



Occidental  
BUSINESS PARK

STARBUCKS HQ



DRIVE TIMES

DOWNTOWN SEATTLE 10 MIN

SEATAC AIRPORT 20 MIN

The information contained herein has been obtained from reliable sources, but is not guaranteed. A prospective buyer/tenant should verify each item relating to this property and all information contained herein.

George Rockwell, SIOR  
(206) 336-5328  
grockwell@andoverco.com

Shane Mahvi, SIOR  
(206) 336-5338  
smahvi@andoverco.com

THE ANDOVER  
COMPANY, INC.  
CORFAC INTERNATIONAL

