

WAREHOUSE DISTRIBUTION FACILITY

ANDOVER PARK WEST

TUKWILA, WA

32,021 SF

FOR
LEASE



1040 MINKLER BLVD

- 32,021 TOTAL SQUARE FEET
- 3,500 SF OF OFFICE
- 2 DOCK HIGH
- 1 LARGE GRADE LEVEL
- 24' CEILING HEIGHT
- ABUNDANT CAR PARKING
- COULD BE AN EXCELLENT ATHLETIC USE AS WELL
- \$0.70 PSF ON SHELL + NNN
- \$1.00 PSF ON EXISTING OFFICE



GEORGE ROCKWELL, SIOR
(206) 679-7625
grockwell@andoverco.com

 **THE ANDOVER
COMPANY, INC.**
CORFAC INTERNATIONAL

FLOOR PLANS

KEY:

● GRADE LEVEL

▲ DOCK HIGH

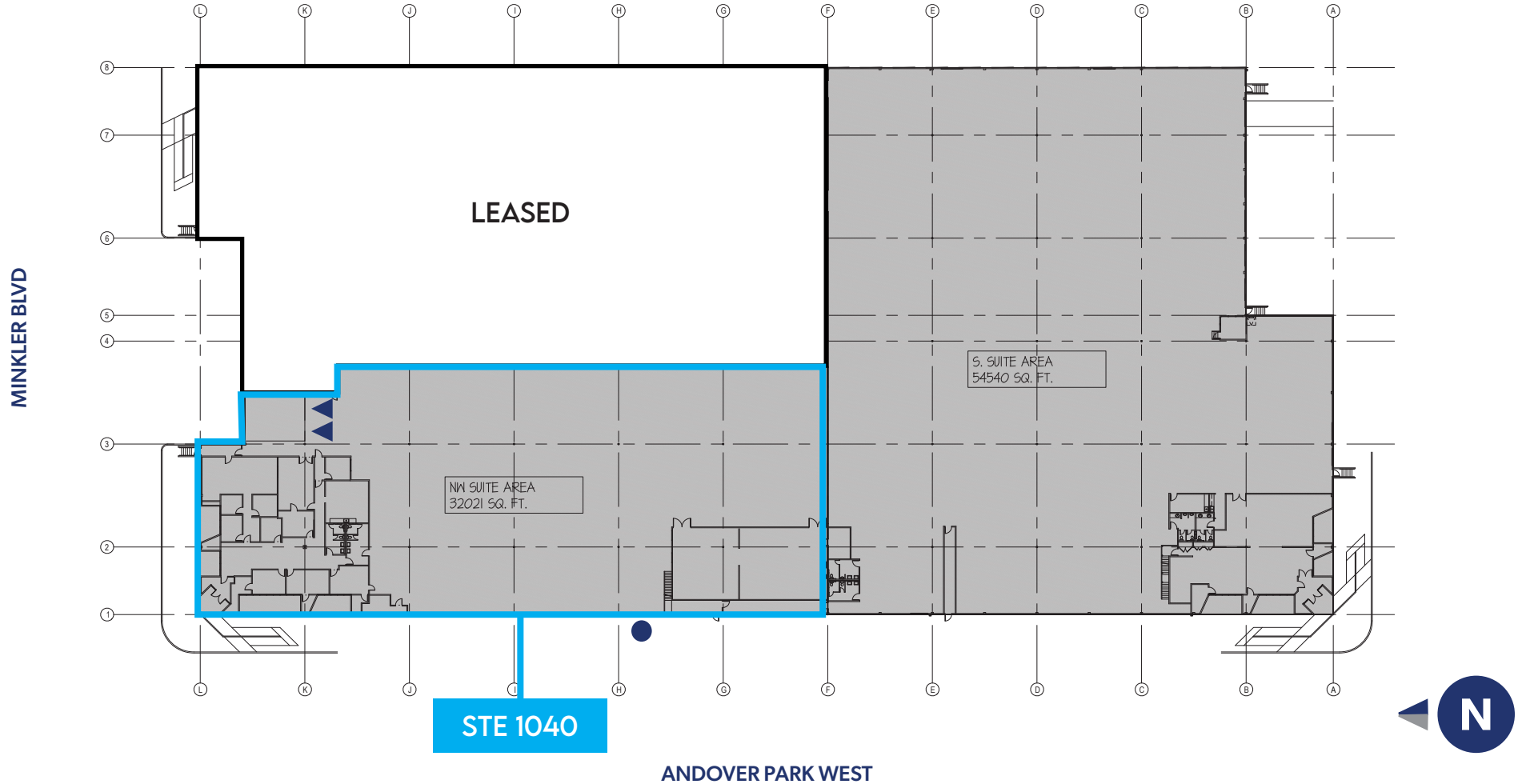

The information contained herein has been obtained from reliable sources, but is not guaranteed. A prospective buyer/tenant should verify each item relating to this property and all information contained herein.

GEORGE ROCKWELL, SIOR
 (206) 679-7625
grockwell@andoverco.com

THE ANDOVER COMPANY, INC.
 CORFAC INTERNATIONAL