

FOR LEASE  
A103: 9,301 SF

# WEST PARK CORPORATE CAMPUS

1220 37<sup>TH</sup> ST NW | AUBURN, WA



## DOCK HIGH WAREHOUSE/OFFICE SPACE

### FEATURES

- 9,301 SF total
- Includes 2,369 SF office
- Office can be reduced to 1,397 SF
- 2 dock high doors, 1 oversized grade level door
- 3-phase power
- 30' clear height
- Excellent office layout
- Sprinklered
- Excellent Highway 167 frontage
- Class A image
- Excellent access and proximity to I-5, SR-18 and Hwy-167
- Built in 2000
- **Please call brokers for rates, NNN's and to arrange tours**

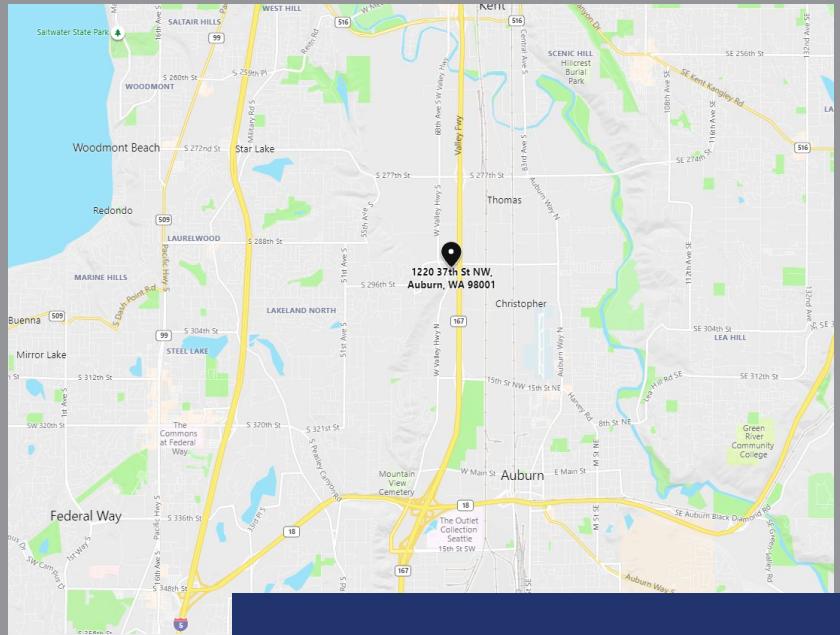

#### EXCLUSIVELY OFFERED BY:

**Arne Svendsen**  
(206) 947-2885  
[asvendsen@andoverco.com](mailto:asvendsen@andoverco.com)

**Brian Bruininks, CCIM**  
(206) 856-6249  
[bbruininks@andoverco.com](mailto:bbruininks@andoverco.com)



THE ANDOVER COMPANY, INC./CORFAC INTERNATIONAL  
900 SW 16th St, Ste 100 | Renton, WA 98057 | (206) 244-0770 | [www.andoverco.com](http://www.andoverco.com)

West Park Corporate Campus is owned and operated by:



The information contained herein has been obtained from reliable sources, but is not guaranteed. A prospective buyer/tenant should verify each item relating to this property and all information contained herein.



FOR LEASE  
A103: 9,301 SF

# WEST PARK CORPORATE CAMPUS

1220 37<sup>TH</sup> ST NW | AUBURN, WA



## ADDRESSES

- Building **A**: 1220 37th St NW
- Building **B**: 3500 W Valley Hwy N
- Building **C**: 3402 W Valley Hwy N
- Building **D**: 3320 W Valley Hwy N

### EXCLUSIVELY OFFERED BY:

**Arne Svendsen**  
(206) 947-2885  
[asvendsen@andoverco.com](mailto:asvendsen@andoverco.com)

**Brian Bruininks, CCIM**  
(206) 856-6249  
[bbruininks@andoverco.com](mailto:bbruininks@andoverco.com)

West Park Corporate Campus is owned and operated by:



THE ANDOVER COMPANY, INC./CORFAC INTERNATIONAL  
900 SW 16th St, Ste 100 | Renton, WA 98057 | (206) 244-0770 | [www.andoverco.com](http://www.andoverco.com)



*The information contained herein has been obtained from reliable sources, but is not guaranteed. A prospective buyer/tenant should verify each item relating to this property and all information contained herein.*

FOR LEASE  
A103: 9,301 SF

# WEST PARK CORPORATE CAMPUS

1220 37<sup>TH</sup> ST NW | AUBURN, WA

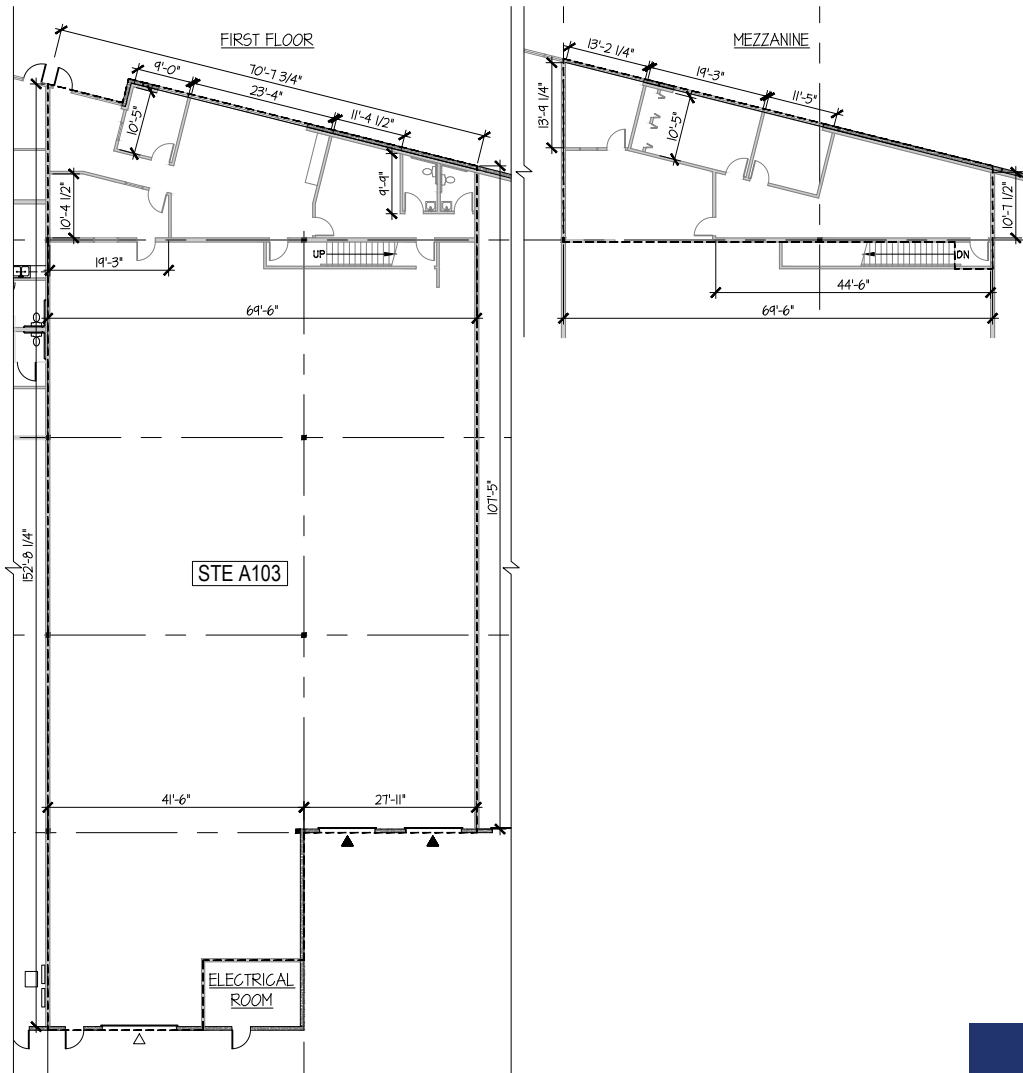

**A103**

## EXCLUSIVELY OFFERED BY:

**Arne Svendsen**  
(206) 947-2885  
[asvendsen@andoverco.com](mailto:asvendsen@andoverco.com)

**Brian Bruininks, CCIM**  
(206) 856-6249  
[bbruininks@andoverco.com](mailto:bbruininks@andoverco.com)

West Park Corporate Campus is owned and operated by:



THE ANDOVER COMPANY, INC./CORFAC INTERNATIONAL  
900 SW 16th St, Ste 100 | Renton, WA 98057 | (206) 244-0770 | [www.andoverco.com](http://www.andoverco.com)



The information contained herein has been obtained from reliable sources, but is not guaranteed. A prospective buyer/tenant should verify each item relating to this property and all information contained herein.