

TUKWILA INDUSTRIAL

1224 - 1226 ANDOVER PARK E | TUKWILA, WA

FOR SALE OR LEASE
26,674 SF TOTAL

BUILDING FEATURES:

CELL TOWER INCOME
SOLAR POWER SAVINGS
NEW LED LIGHTING
NEW HVAC UNIT
NEW OFFICE/SHOWROOM
NEW SECURITY SYSTEM

SHANE MAHVI, SIOR
206-336-5338
smahvi@andoverco.com

BRIAN BRUININKS, CCIM
206-336-5324
bbruininks@andoverco.com

THE ANDOVER
COMPANY, INC.
CORFAC INTERNATIONAL

TUKWILA INDUSTRIAL

1224 - 1226 ANDOVER PARK E | TUKWILA, WA

PROPERTY HIGHLIGHTS

- 26,674 SF TOTAL
- 3,984 SF OFFICE (2,112 SF & 1,872 SF)
- 24' CLEAR HEIGHT
- 5 DOCK HIGH DOORS
- 1.02 AC SITE
- APPROX. 32 PARKING STALLS (POTENTIAL FOR ADDITIONAL)
- 32 PARKING STALLS
- FREE STANDING BUILDING
- HEAVY POWER (BUYER TO VERIFY)
- CONCRETE BUILDING
- SPRINKLERED
- BUILDING CAN BE DEMISED TO TWO SPACES

PLEASE CONTACT BROKERS FOR PRICING

PROPERTY FEATURES

- CELL TOWER INCOME
- SOLAR POWER SAVINGS
- NEW MOTION SENSORED WAREHOUSE LED LIGHTING
- NEW HVAC UNIT
- WHITE-BOXED WAREHOUSE AREA
- NEWLY IMPROVED NORTH END OFFICE/SHOWROOM AREA
- NEW BUILDING SECURITY SYSTEM IN PLACE

DO NOT DISTURB CURRENT OWNER/USER.
ARRANGE ALL SITE VISITS WITH LISTING AGENTS.

FOR SALE OR LEASE
26,674 SF TOTAL

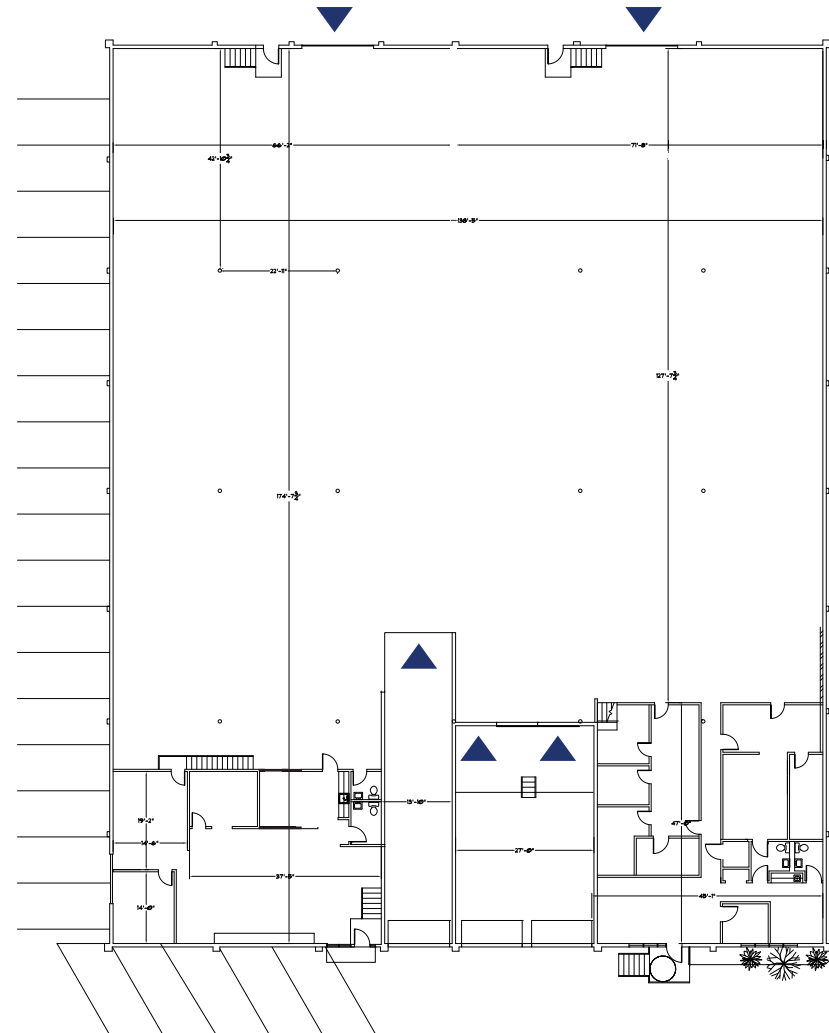

▲ Dock high door

TUKWILA INDUSTRIAL

1224 - 1226 ANDOVER PARK E | TUKWILA, WA

PROPERTY HIGHLIGHTS (HALF BUILDING)

+/- 13,337 SF TOTAL

+/- 2,112 SF OFFICE

4 DOCK DOORS (1 SHARED)

AMPLE PARKING

SPRINKLERED

AVAILABLE NOW

CONTACT BROKERS FOR LEASE RATES

ABILITY TO LEASE FULL OR HALF OF THE BUILDING

DO NOT DISTURB CURRENT OWNER/USER.

ARRANGE ALL SITE VISITS WITH LISTING AGENTS.

FOR SALE OR LEASE 26,674 SF TOTAL

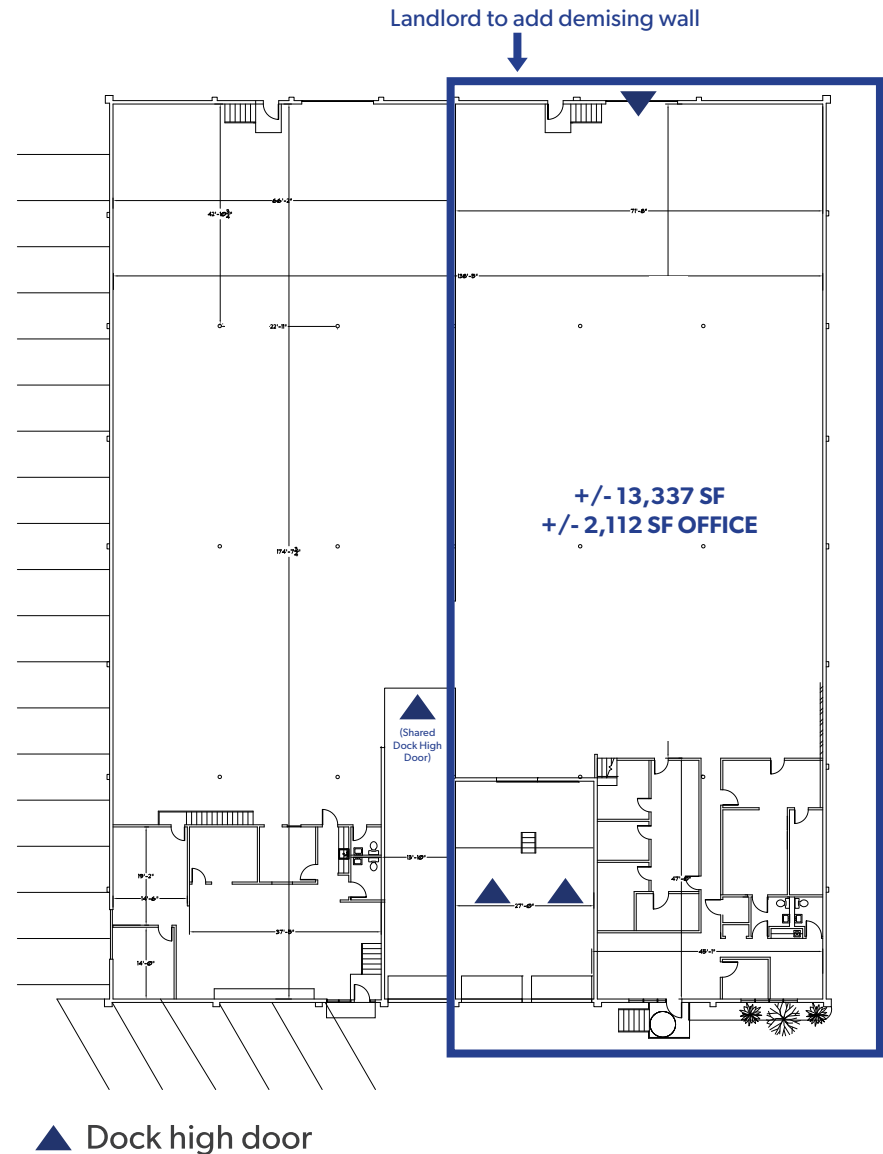

TUKWILA INDUSTRIAL

1224 - 1226 ANDOVER PARK E | TUKWILA, WA



TUKWILA INDUSTRIAL

1224 - 1226 ANDOVER PARK E | TUKWILA, WA



TUKWILA INDUSTRIAL

1224 - 1226 ANDOVER PARK E | TUKWILA, WA



AERIAL

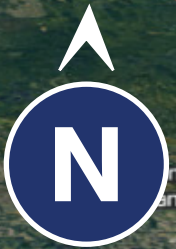

TO SEATTLE

TO BELLEVUE

TUKWILA

BURIEN

SEATAC AIRPORT

RENTON

TUKWILA INDUSTRIAL

DES MOINES

KENT

FEDERAL WAY

TO TACOMA

AUBURN

APPROX. DRIVE TIMES

SEATAC AIRPORT	3.5 MILES
DOWNTOWN BELLEVUE	15 MILES
DOWNTOWN SEATTLE	10 MILES

TUKWILA INDUSTRIAL

1224 - 1226 ANDOVER PARK E | TUKWILA, WA

FOR SALE OR LEASE

26,674 SF TOTAL

CONTACT

SHANE MAHVI, SIOR

206-336-5338

smahvi@andoverco.com

BRIAN BRUININKS, CCIM

206-336-5324

bbruininks@andoverco.com

The information contained herein has been obtained from reliable sources, but is not guaranteed. A prospective buyer/tenant should verify each item relating to this property and all information contained herein.