

FOR LEASE

11,278 SF

9520 FRONT ST S  
LAKEWOOD, WA 98499



## FEATURES

- 11,278 total SF
- 1,387 SF of office
- 4 dock high doors
- 1 grade-level door
- 28' clear height
- ESFR sprinklers
- Excellent access to I-5 and SR-512
- Immediate Availability
- Contact Broker for Rates

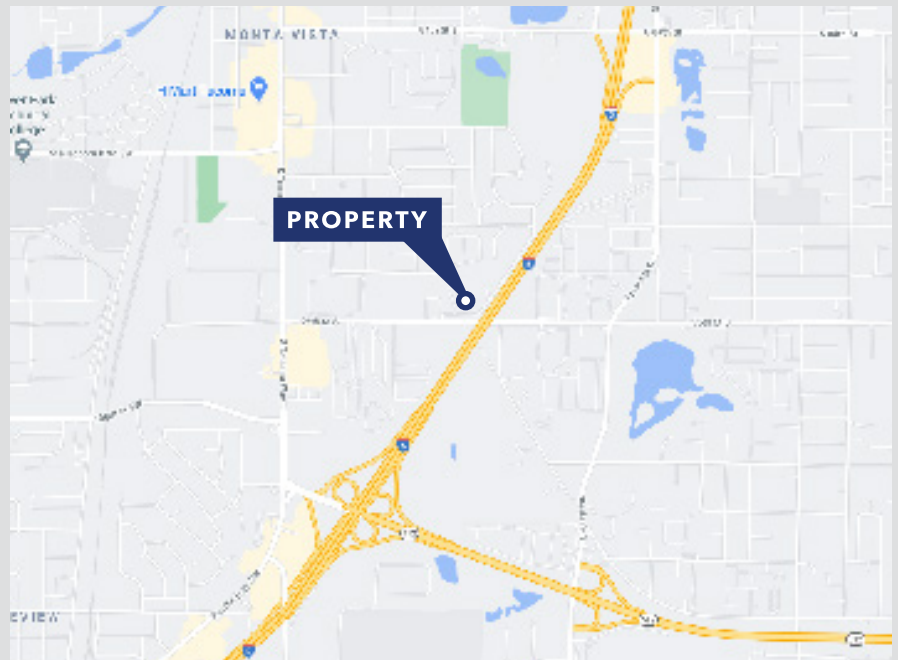

EXCLUSIVELY OFFERED BY:

George Rockwell, SIOR  
(206) 679-7625  
grockwell@andoverco.com



THE ANDOVER COMPANY, INC./CORFAC INTERNATIONAL  
900 SW 16th St, Ste 100 | Renton, WA 98057 | (206) 244-0770 | [www.andoverco.com](http://www.andoverco.com)

The information contained herein has been obtained from reliable sources, but is not guaranteed. A prospective buyer/tenant should verify each item relating to this property and all information contained herein.

FOR LEASE

11,278 SF

9520 FRONT ST S

LAKEWOOD, WA 98499

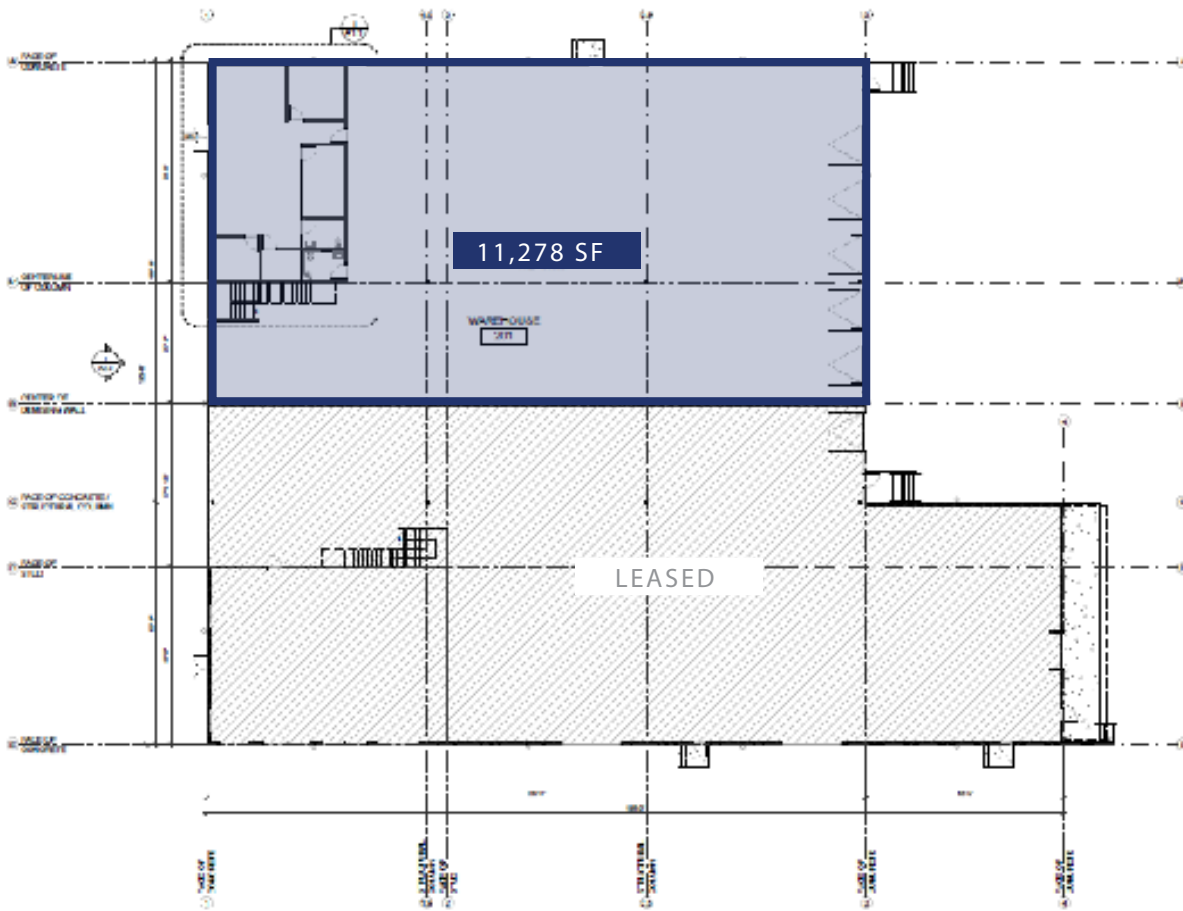

EXCLUSIVELY OFFERED BY:

George Rockwell, SIOR  
(206) 679-7625  
grockwell@andoverco.com



THE ANDOVER COMPANY, INC./CORFAC INTERNATIONAL  
900 SW 16th St, Ste 100 | Renton, WA 98057 | (206) 244-0770 | [www.andoverco.com](http://www.andoverco.com)

The information contained herein has been obtained from reliable sources, but is not guaranteed. A prospective buyer/tenant should verify each item relating to this property and all information contained herein.